

American Orthopaedic Cast Cutter

The Cast Cutter is a specialized tool designed for the removal of padded casts. It is not for consumer use and should be used only by qualified personnel trained in proper techniques of cast removal.

WARNINGS*

The blade oscillates rapidly and becomes very warm if pushed through the cast using constant pressure. Read instructions completely, to assure proper operation.

Appropriate selection, use and maintenance of a sharp blade is necessary for safe, efficient cast removal. Extra friction caused by a dull blade will create excessive blade heat. **DO NOT ATTEMPT** to cut non-plaster cast materials with blades recommended for plaster casts.

Dull or damaged blades should never be used. While in use, keep hands away from the oscillating blade.

The following items should be considered when operating the Cast Cutter:

- Grounding continuity should be checked periodically.
- Electrical repairs must only be made by a qualified technician.
- The power supply cord should be kept away from the cutting area at all times.
- When disconnecting the Cast Cutter from an outlet, pull on the plug. Never disconnect by pulling on the cord.
- In order to assure proper grounding, plug the unit in receptacle marked "Hospital Grade."
- Do not operate in areas where flammable or explosive vapors may be present.
- Do not autoclave or immerse in any liquid.
- Disconnect power cord before changing blade.

CAUTIONS

Consideration should be given to the airborne dust created when certain cast materials are removed. An accessory dust collection system[†] has proven effective in removing most dust created by the cutting action of the oscillating blade. Ear protection should be considered when cutting materials that create excessive noise.

This equipment generates, uses and can radiate radio frequency energy and, if not installed and used in accordance with the instructions, may cause harmful interference to other devices in the vicinity. However, there is no guarantee that interference will not occur in a particular installation.

[†] 0295-401 (74470-17) 230 Volt
0295-400 (74470-16) 115 Volt

If this equipment does cause harmful interference to other devices, which can be determined by turning the equipment off and on, the user is encouraged to try to correct the interference by one or more of the following measures:

- Reorient or relocate the receiving device.
- Increase the separation between the equipment.
- Connect the equipment into an outlet on a circuit different from that to which the other device(s) are connected.
- Consult the manufacturer or field service technician for help.

MAINTENANCE, CARE AND SERVICE

Bearing Lubrication – None required, lubricated for life. The unplugged unit may be cleaned with a soft damp cloth.

NOTE: Blade life can be extended by periodically repositioning the blade on the drivehead.

The Electric Cast Cutter is a specialized tool. If the unit or the line cord should become inoperable, or is damaged, return it, with a description of the problem, to your distributor or to the factory for appropriate service.

The manufacturer considers itself only as responsible for the consequences regarding safety, reliability and performance of the unit if:

- no expansions and alterations are carried out on the cast cutter.
 - repairs are carried out by persons authorized by the Manufacturer
 - the electrical installations are in accordance with IEC-regulations.
 - the unit is operated and handled in accordance with Instructions of Use.
- For repairs use only original replacement parts.

OPERATION

The cast is removed utilizing a series of up and down motions combined with linear movement. Hold the unit with one hand as illustrated, move the switch to the "ON" position and, using the thumb as a gauge, depress blade into the cast.

The blade should be inserted at a slight angle into the cast until the cutting pressure lessens, indicating that the blade is through the cast and is touching the padding. The blade should then be lifted leaving the tip in the cutting groove and advance along the cutting line for about one-half inch and repeat as above. DO NOT exert excessive working pressure. DO NOT use on non-padded casts. DO NOT attempt to cut skin-tight casts.

Connection and disconnection from the power main is achieved by plugging and unplugging the unit from the receptacle.

ACCESSORIES

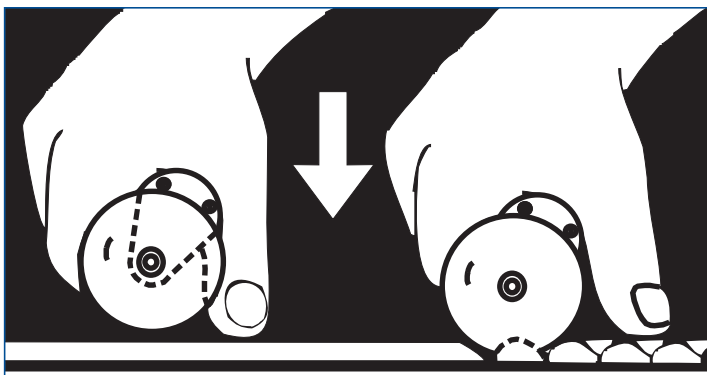

Ref. No.	Description	NART No.
4183-110	Blade 50 mm (2.0") dia. for plaster	74472-25
4183-112	Blade 65 mm (2.5") dia. for plaster	74472-26
4183-114	Blade 50 mm (2.0") dia. for synthetic (Teflon®)	74472-27
31-0265	Blade 65 mm (2.5") dia. for synthetic (Teflon®)	72033-15
0295-225	Blade 50 mm (2.0") dia. for synthetic (Dicronite®)	74472-03
0295-226	Blade 65 mm (2.5") dia. for synthetic (Dicronite®)	74472-05
31-0168	Blade 65 mm (2.5") dia. Titanium Nitride	72033-05
0295-401	Cast dust vacuum mobile, 230 VAC	74470-17
0295-400	Cast dust vacuum mobile, 115 VAC	74470-16

SPECIFICATIONS & DEFINITIONS

 Type B equipment

I ON

 Alternating Current

O OFF

 Attention!
Consult
Accompanying
Documents

INT Intermittent
operation, consult
accompanying
documents

When removing non-plaster cast materials, the selection and use of specialized blades (Teflon® or Dicronite® coated blades) will assure cooler operation and minimize the load on mechanical parts located inside the Cast Cutter. DO NOT ATTEMPT to cut non-plaster cast materials with blades recommended for plaster removal.

Dicronite® is a registered trademark of Lubrication Sciences, Inc.
Teflon® is a registered trademark of E.I. du Pont de Nemours and Company.

Blade Installation Hexagonal Cast Saw Blades

1. Unplug saw from hospital grade receptacle.
2. Remove blade nut (5), lockwasher (4) and recessed spacer (3) from the drivehead (1).
3. Install the blade (2) so that the blade seats flush against the shoulder of the drivehead (1).
4. Next, place the recessed spacer (3) on the drivehead (1) so the counter sunk edge fits over the projecting hexagonal shoulder.
5. Place the lockwasher (4) next to the recessed spacer (3).
6. Replace the blade nut (5) and tighten firmly with the wrench.

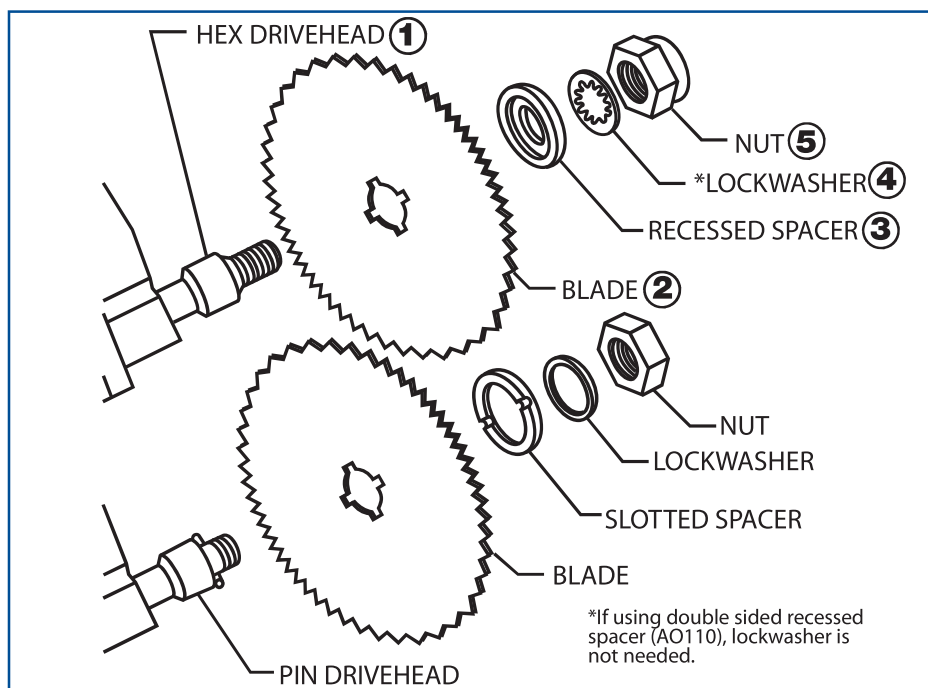

American Orthopaedic/ BSN medical Cast Cutter

Cast Removal Saw

WARRANTY SERVICE PROCEDURES

Warranty service may be obtained by returning the inoperative product to any authorized BSN medical products distributor or directly to BSN medical Inc., 100 Beiersdorf Drive, Rutherford College, NC 28671, USA. You may call BSN medical Inc., at 1-828-879-5100 Ext. 4301 for information regarding the location of the authorized distributor nearest you. If the product must be shipped to a distributor or to BSN medical Inc. to obtain warranty repairs, you will be responsible for the shipping charges

LIMITED WARRANTY

This product is warranted by BSN medical Inc. to be free from defects in material and workmanship for a period of ONE YEAR from the date of its purchase by the original user. This warranty is granted only to the original user and is subject to the following provisions:

WHAT IS NOT COVERED

- Parts such as blades, that require replacement under normal use.
- Damage or malfunction resulting from:
 - (1) Negligent use or misuse of the product,
 - (2) Use with improper voltage or current,
 - (3) Use contrary to the operating instructions and limitations stated herein,
 - (4) Improper maintenance,
 - (5) Improper assembly, or
 - (6) Alterations or modifications to the product which adversely affect the product's operation, performance or durability or that change the product's intended use.

DISCLAIMER OF IMPLIED WARRANTY

To the extent it is permissible by law, BSN medical Inc. disclaims all implied warranties, including any warranty of MERCHANTABILITY and any warranty for FITNESS FOR A PARTICULAR PURPOSE. There are no warranties which extend beyond the limited express warranty described above. Should any warranty be implied by law in connection with the purchase of this product by the original user despite the foregoing disclaimer, including any warranty for FITNESS FOR A PARTICULAR PURPOSE, such warranty shall be limited to the one year limited express warranty period.

REMEDY

BSN medical Inc. will, at its option, repair or replace a defective product that is covered by this warranty pursuant to the terms for –“Warranty Service Procedures” stated above. The remedy for breach of warranty is strictly and exclusively limited to repair or replacement of nonconforming products and BSN medical Inc. does not authorize anyone, including but not limited to its distributors, to extend or offer any additional remedy. IN NO EVENT SHALL BSN medical BE LIABLE FOR ANY CONSEQUENTIAL OR INCIDENTAL DAMAGES. Some States do not allow the exclusion or limitation of incidental or consequential damages so the above limitation or exclusion may not apply to you.

THIS WARRANTY GIVES YOU SPECIFIC LEGAL RIGHTS. YOU MAY ALSO HAVE OTHER RIGHTS WHICH VARY FROM STATE TO STATE.

The American Orthopaedic / BSN medical Cast Cutter cast removal saw is a specialized tool. If the unit should become inoperable, or is damaged, return it, with a description of the problem, to your distributor or to the factory for appropriate service.



100 Beiersdorf Drive, Rutherford College, NC 28671, USA
To order toll free: 1-800-537-1063
Tel.: 704-554-9933 Fax: 1-800-835-4325 www.bsnmedical.com



BSN medical GmbH
Quickbornstrasse 24
D - 20253 Hamburg



American Orthopaedic/ BSN medical Cast Cutter

Cast Removal Saw



115V Hex drive
Model No. 0295-200
Nart: 74470-10

115V Pin drive
Model No. 0295-202
Nart: 74470-11

230V Hex drive
Model No. 0295-260
Nart: 74470-12

This Owner's Manual
and these Operating
Instructions should
be read completely prior
to operating
the equipment.